

Thursday, March 26, 2009

DOCUMENT 2008-809T
CREDIT VALLEY CONSERVATION AUTHORITY BUILDING EXPANSION
ADDENDUM #3

Number of Pages: 2

Referring to the above Document 2008-809T, the following are responses to the questions raised:

1. **Clarifications**

- 1.1 Add note on Architectural Drawing 1/A10.02, as follows:
"General Note: 1. Doors are 45mm Thick unless otherwise noted"

2. **Specifications**

2.1 **Revisions to Specifications – Divisions 2 through 14**

- 2.1.1 **Delete:** Under Section 09310 Ceramic Tile delete sentence 2.1.2.4
Replace with: 2.1.2.4 CT-4: natural slate tile nominal 300x600mm;
.1 Acceptable Products;
.1 Pizarra Purple, as supplied by Stone Tile International.

- 2.1.2 **Add:** Under Section 09681 Carpet Tile, add Sentence 2.1.1.2 as follows:
"2.1.1.2 Reincarnation in Greige (8905), by Interface Flooring

3. **Mechanical**

- 3.1 Refer to Mechanical Addendum No. 3 attached in entirety. Issued by MV Shore Associated Ltd dated March 26, 2009. (Two [2] pages in total)
.1 As per attached Instruction (One [1] pages in total)
.2 as per attached Sketch MSK-3.1 (One [1] pages in total)

4. **Drawings:**

4.1 **Architectural Detail Drawings issued with this addendum**

- 4.1.1 Add Drawing D2.33 "SECTION Detail: North WALL/WS.3 WALL PARAPET"
.1 as per attached D233, issued for Addendum No 3 and attached in entirety.

4.2 **Revisions to Architectural Drawings (see attached)**

- 4.2.1 Revise Drawing D2.09 "SECTION DETAIL : WEST CURTAIN WALL & WS.1 PARAPET" as follows:
.1 as per attached D209, issued for Addendum No 3 and attached in entirety.
Note clouded/bubbled revisions.

- 4.2.2 Revise Drawing D2.18 "SECTION DETAIL : GARAGE ENTRY" as follows:
.1 as per attached D218, issued for Addendum No 3 and attached in entirety.
Note clouded/bubbled revisions.

- .2 as per attached Sketch AD3-003. Note clouded/bubbled revisions.

DOCUMENT 2008-809T
CREDIT VALLEY CONSERVATION AUTHORITY BUILDING EXPANSION
ADDENDUM #2

- 4.2.3 Revise Drawing D2.22 "SECTION DETAIL : WS.2 PARAPET (TYP)" as follows:
.1 as per attached D222, issued for Addendum No 3 and attached in entirety. Note clouded/bubbled revisions.
- 4.2.4 Revise Drawing A702 Interior Elevations & Window Schedule as follows:
.1 as per attached Sketch AD3-001 to AD1-002. Note clouded/bubbled revisions.

Attachments:

- | | |
|----------------------------|---|
| 1. Architectural Addendum: | Two (2) pages of Instruction
Four (4) pages of Drawings
Three (3) pages of Sketches |
| 2. Mechanical Addendums: | One (1) page of Instruction
One (1) page of Sketches |

End of Addendum No. 3



Susie Mahendran
Senior Purchasing Analyst

The Addendum number and date must be included in the Form of Tender in order for your bid to be given consideration.

**M. V. SHORE ASSOCIATES (1993) LIMITED
CONSULTING ENGINEERS
1200 EGLINTON AVENUE EAST
SUITE #402
DON MILLS, ONTARIO
M3C 1H9**

**To: Montgomery Sisam
197 Spadina Ave.
Suite 301
Toronto, Ontario**

March 26, 2009

**Att'n: Geordon Green
Re: CVC Authority Office Building Expansion
& Existing Building Renovation**

Fax: 416-364-7723

Ref. No: 07-050

MECHANICAL ADDENDUM #3

1. General:-

This Addendum shall be supplemental to and form part of the Mechanical Drawings.

2. Purpose:-

Clarification and coordination.

3. Changes to Mechanical Drawings:-

Drawing #M-3:- Ground Floor Environmental Lab

(a) REVISE: Provide only an acid neutralizer "SMS Model An-4 for acid neutralization system and to be installed under counter. Delete acid interceptor. Revise associated pipings.

CA

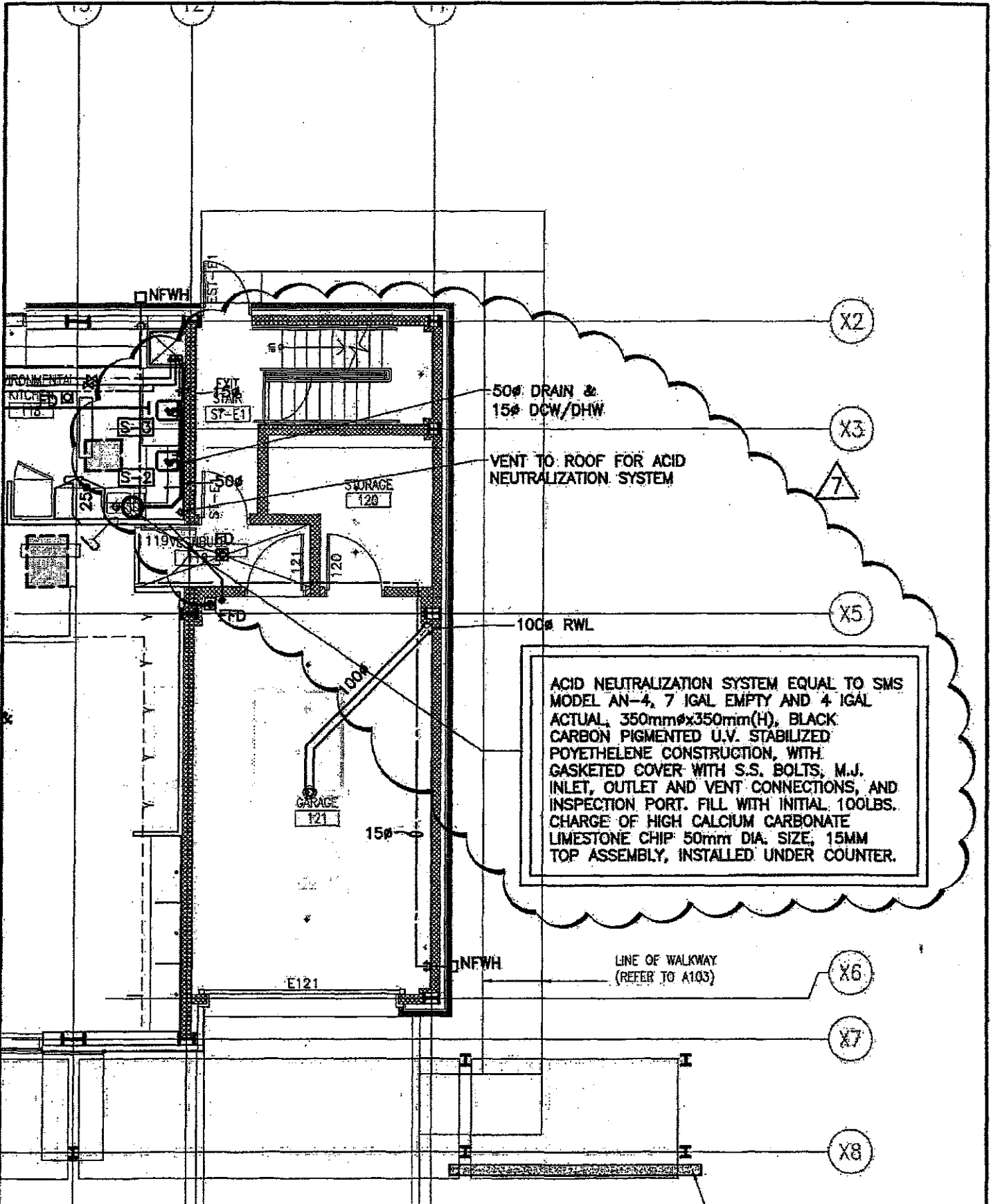

X2

X3

X5

X6

X7

X8



M.V. SHORE
ASSOCIATES (1988) LIMITED

Consulting Professional Engineers

1290 Eglinton Avenue East - Suite 402 - Don Mills - Ontario - Canada - M3C 1H9
Phone (416) 443-1985 - Fax (416) 443-1415

PROJECT
CVC OFFICE BUILDING
1255 OLD DERRY ROAD

MISSISSAUGA ONTARIO

PART OF G/F ENVIRON. LAB.

REVISION No. **7**

ADDENDUM No. **3**

SCALE: **1:100**

REF. DWG.# **M-3**

DATE: **MAR.26, 2009**

JOB: No. **05-048**

DWG. No. **MSK-3.1**

Credit Valley Conservation Authority
Office Building Expansion

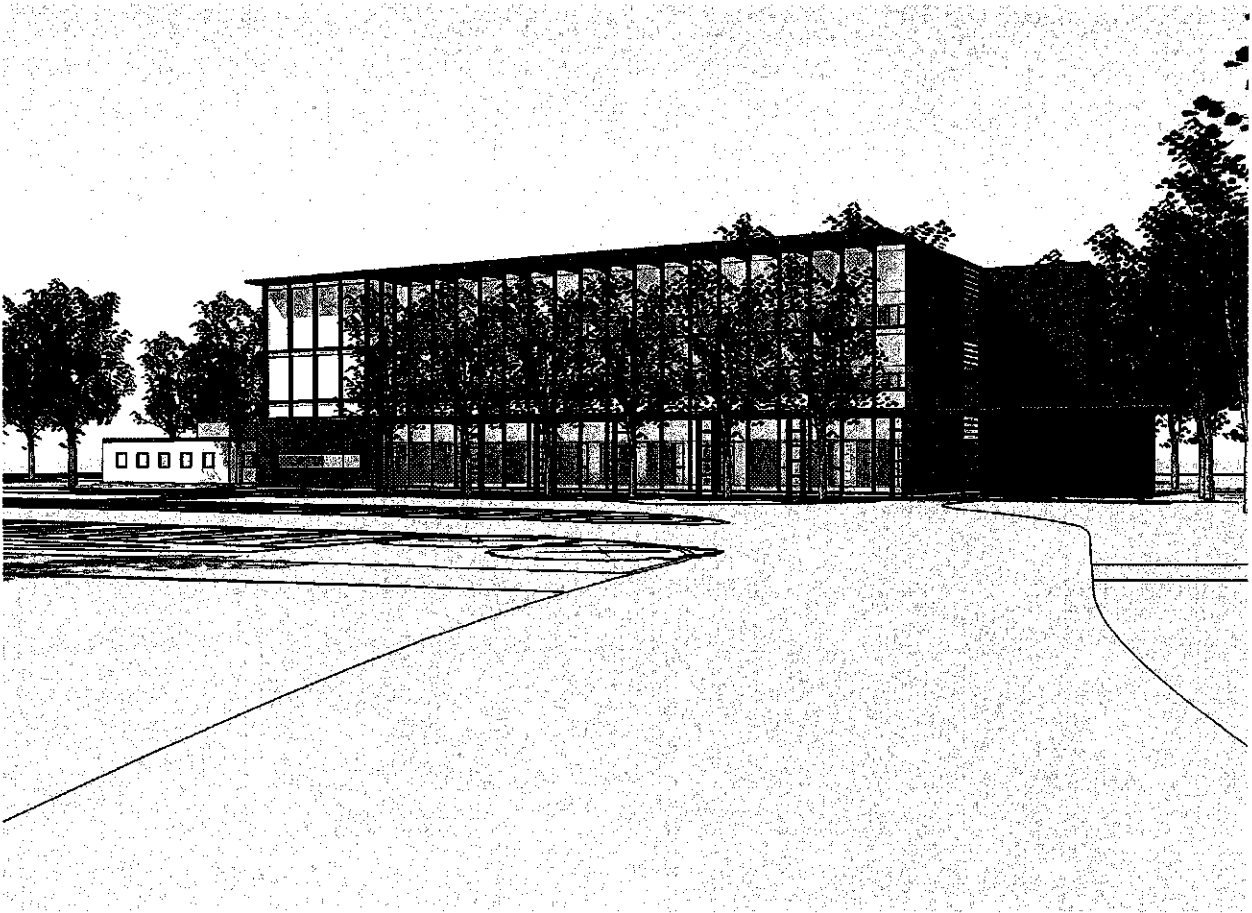

Addendum No. 3

Project No. 7008
Issued for Addendum No. 3

Date: March 23, 2009

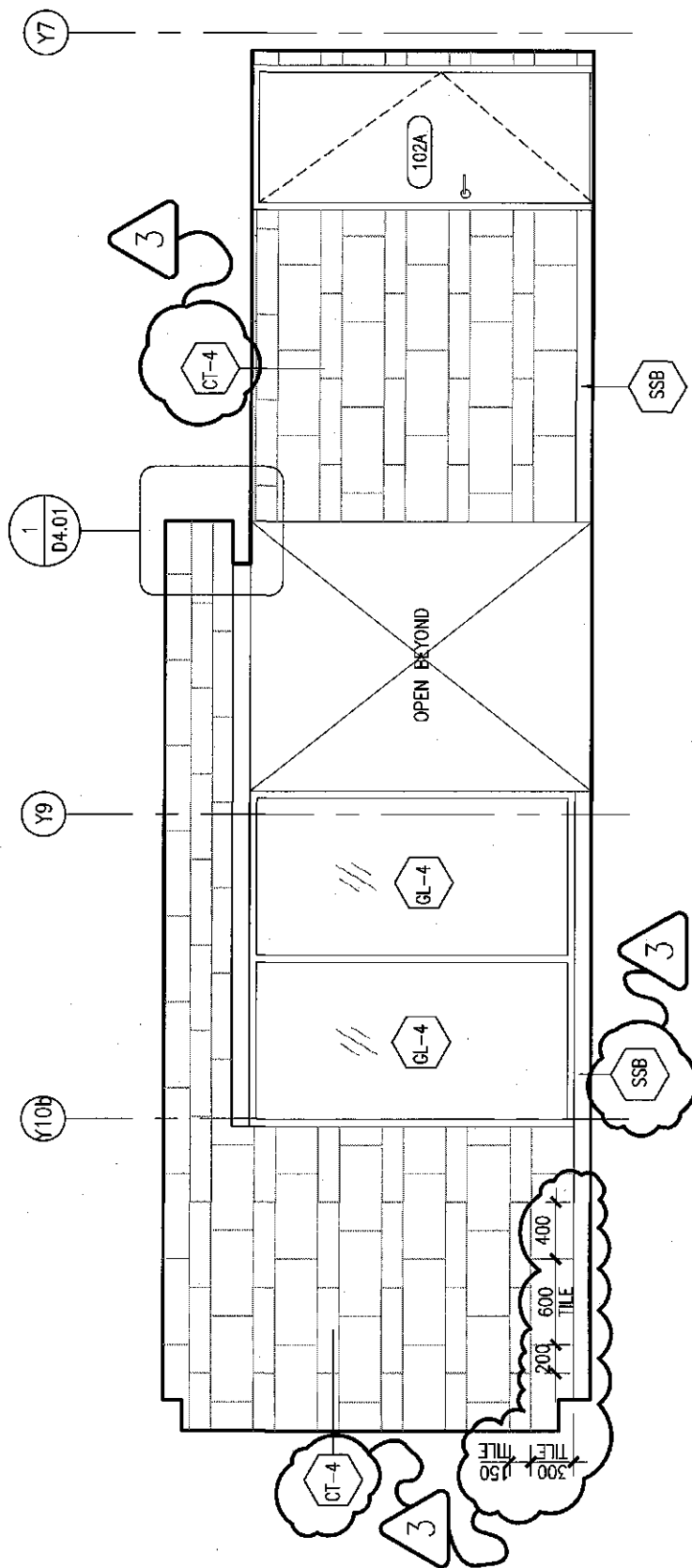

Credit Valley Conservation Authority
 Head Office Building Expansion
 1255 Old Derry Road, Mississauga, Ontario

MONTGOMERY SISAM ARCHITECTS INC.

Interior Elevation - Waiting Area

Issued for Addendum No. 3

scale: 1:100
 drawn by: EC
 reviewed by: GG
 dwg. ref. no: 1/A7.02

job number: 07008
 plot date: March 23, 2009
 drawing no:

AD3-001

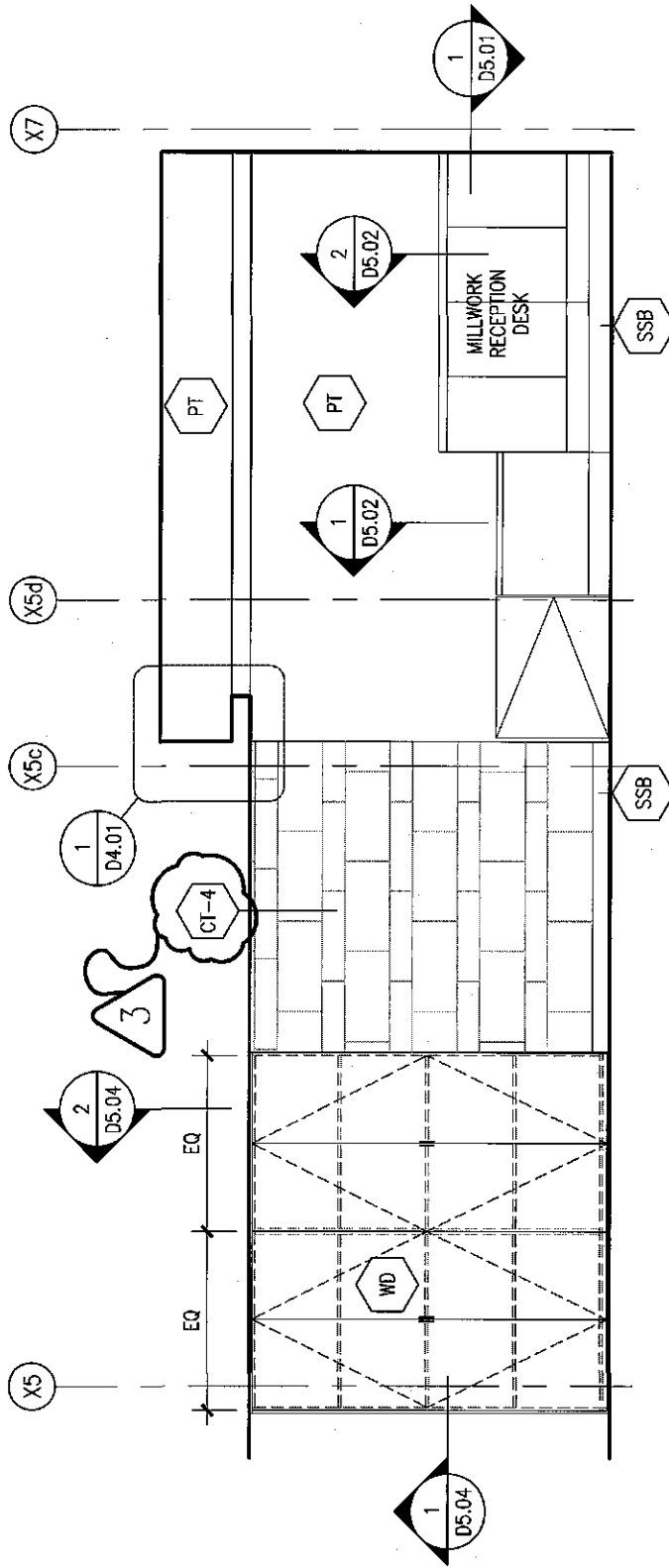

Credit Valley Conservation Authority
 Head Office Building Expansion
 1255 Old Derry Road, Mississauga, Ontario

MONTGOMERY SISAM ARCHITECTS INC.

Interior Elevation - Waiting Area

Issued for Addendum No. 3

scale: 1:100
 drawn by: EC
 reviewed by: GG
 dwg. ref. no: 2/A7.02

job number: 07008
 plot date: March 23, 2009
 drawing no:

AD3-002

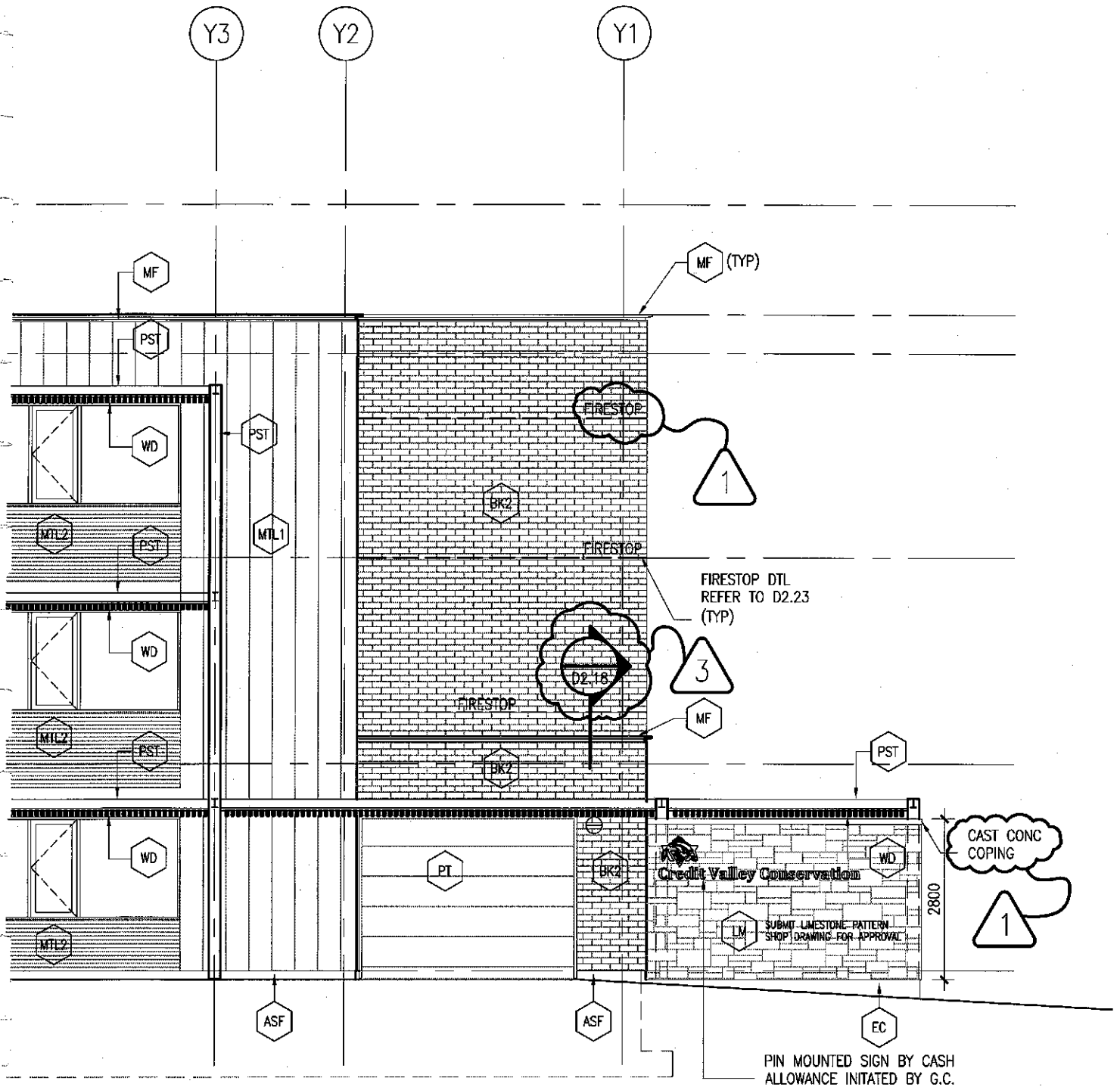

Credit Valley Conservation Authority
 Head Office Building Expansion
 1255 Old Derry Road, Mississauga, Ontario

MONTGOMERY SISAM ARCHITECTS INC.

Elevation - South

Issued for Addendum No. 3

scale: 1:100
 drawn by: EC
 reviewed by: GG
 dwg. ref. no: 2/A4.01

job number: 07008
 plot date: March 23, 2009
 drawing no:

AD3-003

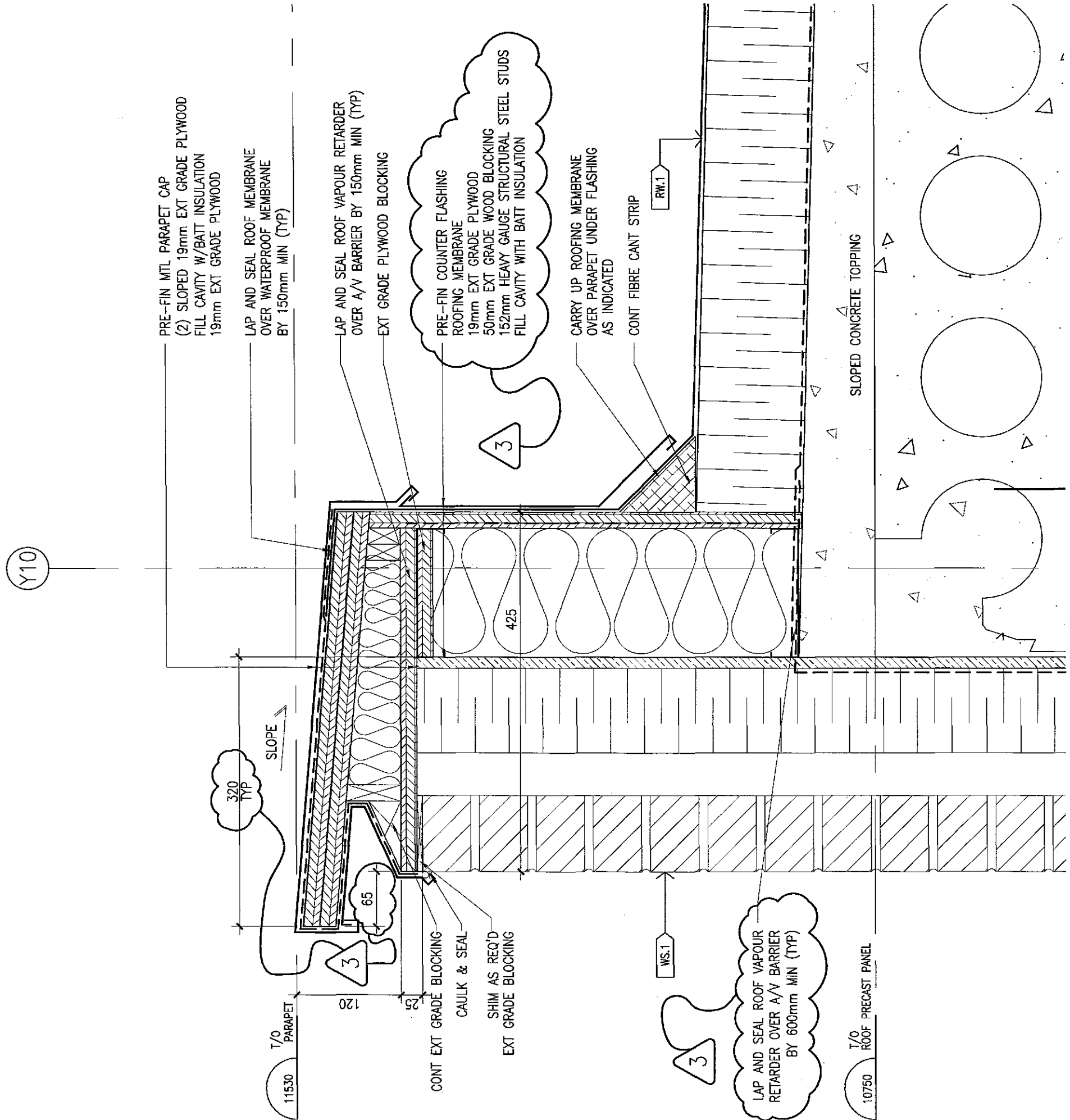

PRE-FIN MTL PARAPET CAP
 (2) SLOPED 19mm EXT GRADE PLYWOOD
 FILL CAVITY W/BATT INSULATION
 19mm EXT GRADE PLYWOOD

LAP AND SEAL ROOF MEMBRANE
 OVER WATERPROOF MEMBRANE
 BY 150mm MIN (TYP)

LAP AND SEAL ROOF VAPOUR RETARDER
 OVER A/V BARRIER BY 150mm MIN (TYP)
 EXT GRADE PLYWOOD BLOCKING

PRE-FIN COUNTER FLASHING
 ROOFING MEMBRANE
 19mm EXT GRADE PLYWOOD
 50mm EXT GRADE WOOD BLOCKING
 152mm HEAVY GAUGE STRUCTURAL STEEL STUDS
 FILL CAVITY WITH BATT INSULATION

CARRY UP ROOFING MEMBRANE
 OVER PARAPET UNDER FLASHING
 AS INDICATED

CONT FIBRE CANT STRIP

LAP AND SEAL ROOF VAPOUR
 RETARDER OVER A/V BARRIER
 BY 600mm MIN (TYP)

SLOPED CONCRETE TOPPING

T/O ROOF PRECAST PANEL

Y10

320
TYP

11530
T/O PARAPET

120

25

425

WS.1

10750

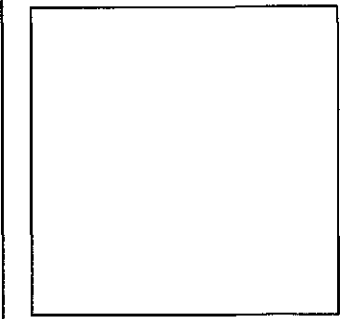

All drawings and specifications are the property of the architect. The contractor shall verify all dimensions and information on site and report any discrepancy to architect before proceeding.

6			
5			
4			
3			
2	09.03.23	ISSUED FOR ADDENDUM NO 3	EC
1	09.02.12	ISSUED FOR TENDER	EC
#	date:	revision:	by:
revisions			

KEY PLAN
 OFFICE BUILDING EXPANSION
 CREDIT VALLEY CONSERVATION AUTHORITY

1255 Old Derry Road, Mississauga, Ontario
 Phone: (905) 670-1615 Fax: (905) 670-2210

SECTION DETAIL
 WEST CURTAIN WALL & WS.1 PARAPET

scale: 1:5
 drawn by: EC
 reviewed by: GG
 job number: 07008
 plot date: FEBRUARY 12, 2009

drawing number:

D2.09

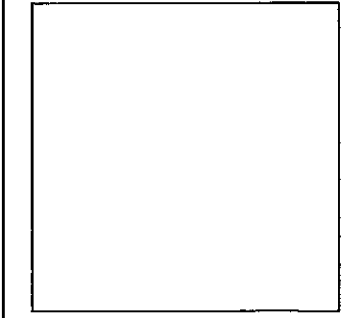

All drawings and specifications are the property of the architect. The contractor shall verify all dimensions and information on site and report any discrepancy to architect before proceeding.

09.03.23	ISSUED FOR ADDENDUM NO 3	EC
09.02.12	ISSUED FOR TENDER	EC
#	date:	revision:
		by:

KEY PLAN
OFFICE BUILDING EXPANSION
CREDIT VALLEY CONSERVATION AUTHORITY

1255 Old Ferry Road, Mississauga, Ontario
Phone: (905) 670-1615 Fax: (905) 670-2210

SECTION DETAIL
GARAGE ENTRY

scale:	1:5
drawn by:	EC
reviewed by:	GG
job number:	07008
plot date:	FEBRUARY 12, 2009

drawing number:

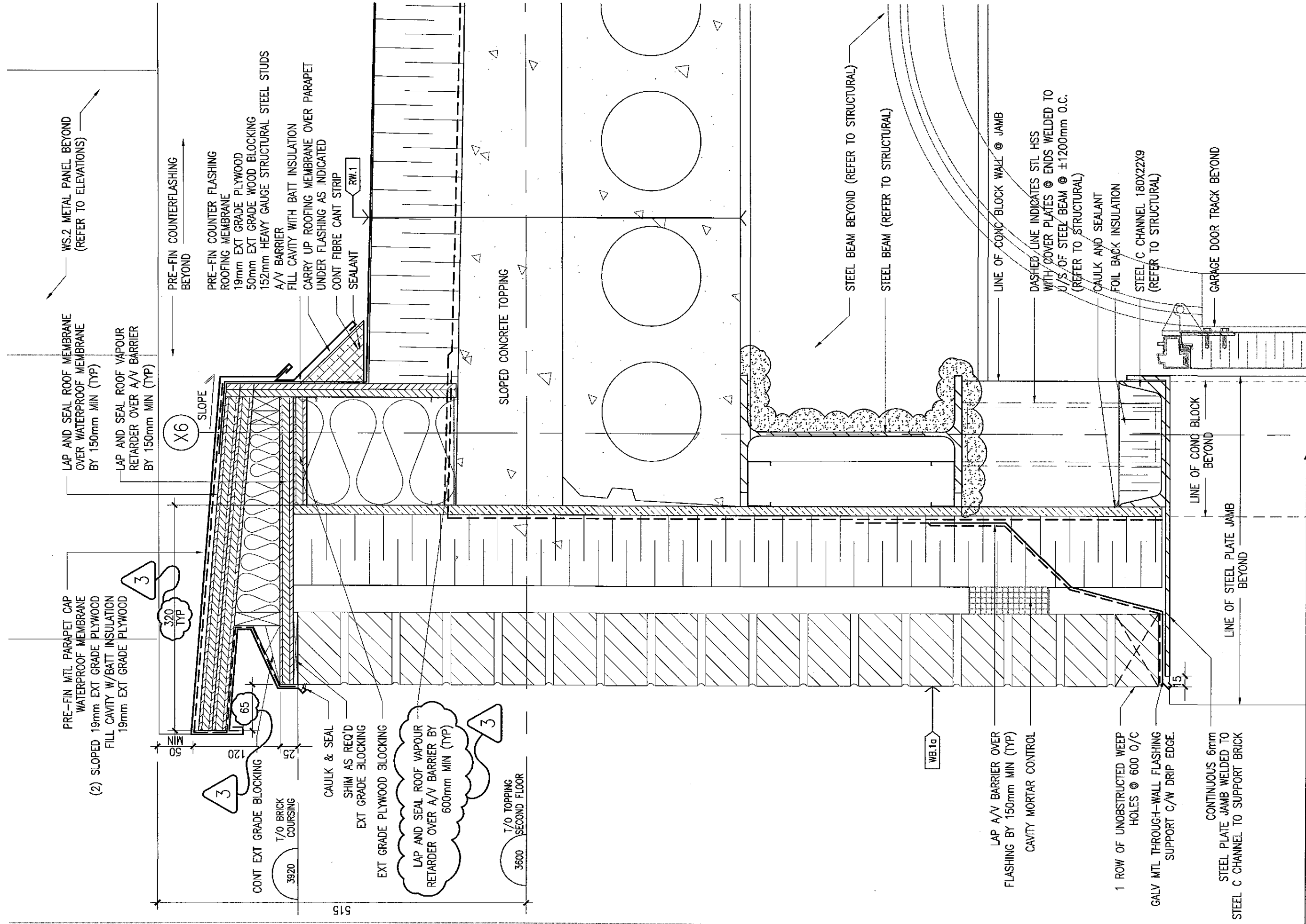

WS.2 METAL PANEL BEYOND
(REFER TO ELEVATIONS)

LAP AND SEAL ROOF MEMBRANE
OVER WATERPROOF MEMBRANE
BY 150mm MIN (TYP)

PRE-FIN MTL PARAPET CAP
WATERPROOF MEMBRANE
19mm EXT GRADE PLYWOOD
FILL CAVITY W/BATT INSULATION
19mm EXT GRADE PLYWOOD

PRE-FIN COUNTERFLASHING
BEYOND

PRE-FIN COUNTER FLASHING
ROOFING MEMBRANE
19mm EXT GRADE PLYWOOD
50mm EXT GRADE WOOD BLOCKING
152mm HEAVY GAUGE STRUCTURAL STEEL STUDS
A/V BARRIER
FILL CAVITY WITH BATT INSULATION
CARRY UP ROOFING MEMBRANE OVER PARAPET
UNDER FLASHING AS INDICATED
CONT FIBRE CANT STRIP
SEALANT

X6
SLOPE

320
TYP

65

CONT EXT GRADE BLOCKING
T/O BRICK
COURSING

CAULK & SEAL
SHIM AS REQ'D
EXT GRADE BLOCKING

EXT GRADE PLYWOOD BLOCKING
LAP AND SEAL ROOF VAPOUR
RETARDER OVER A/V BARRIER BY
600mm MIN (TYP)

T/O TOPPING
SECOND FLOOR

SLOPED CONCRETE TOPPING

STEEL BEAM BEYOND (REFER TO STRUCTURAL)

STEEL BEAM (REFER TO STRUCTURAL)

LAP A/V BARRIER OVER
FLASHING BY 150mm MIN (TYP)
CAVITY MORTAR CONTROL

1 ROW OF UNOBSTRUCTED WEEP
HOLES @ 600 O/C
GALV MTL THROUGH-WALL FLASHING
SUPPORT C/W DRIP EDGE.

CONTINUOUS 6mm
STEEL PLATE JAMB WELDED TO
STEEL C CHANNEL TO SUPPORT BRICK

LINE OF CONG BLOCK WALL @ JAMB

DASHED LINE INDICATES STL HSS
WITH COVER PLATES @ ENDS WELDED TO
U/S OF STEEL BEAM @ ±1200mm O.C.
(REFER TO STRUCTURAL)

CAULK AND SEALANT
FOIL BACK INSULATION
STEEL C CHANNEL 180X22X9
(REFER TO STRUCTURAL)

GARAGE DOOR TRACK BEYOND

LINE OF CONG BLOCK
BEYOND

LINE OF STEEL PLATE JAMB
BEYOND

WB.10

50

120

52

95

3600

15

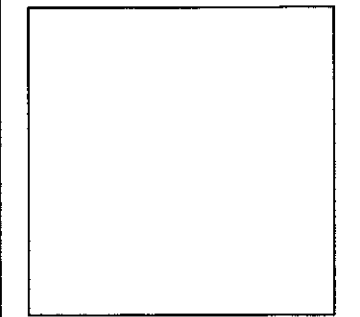
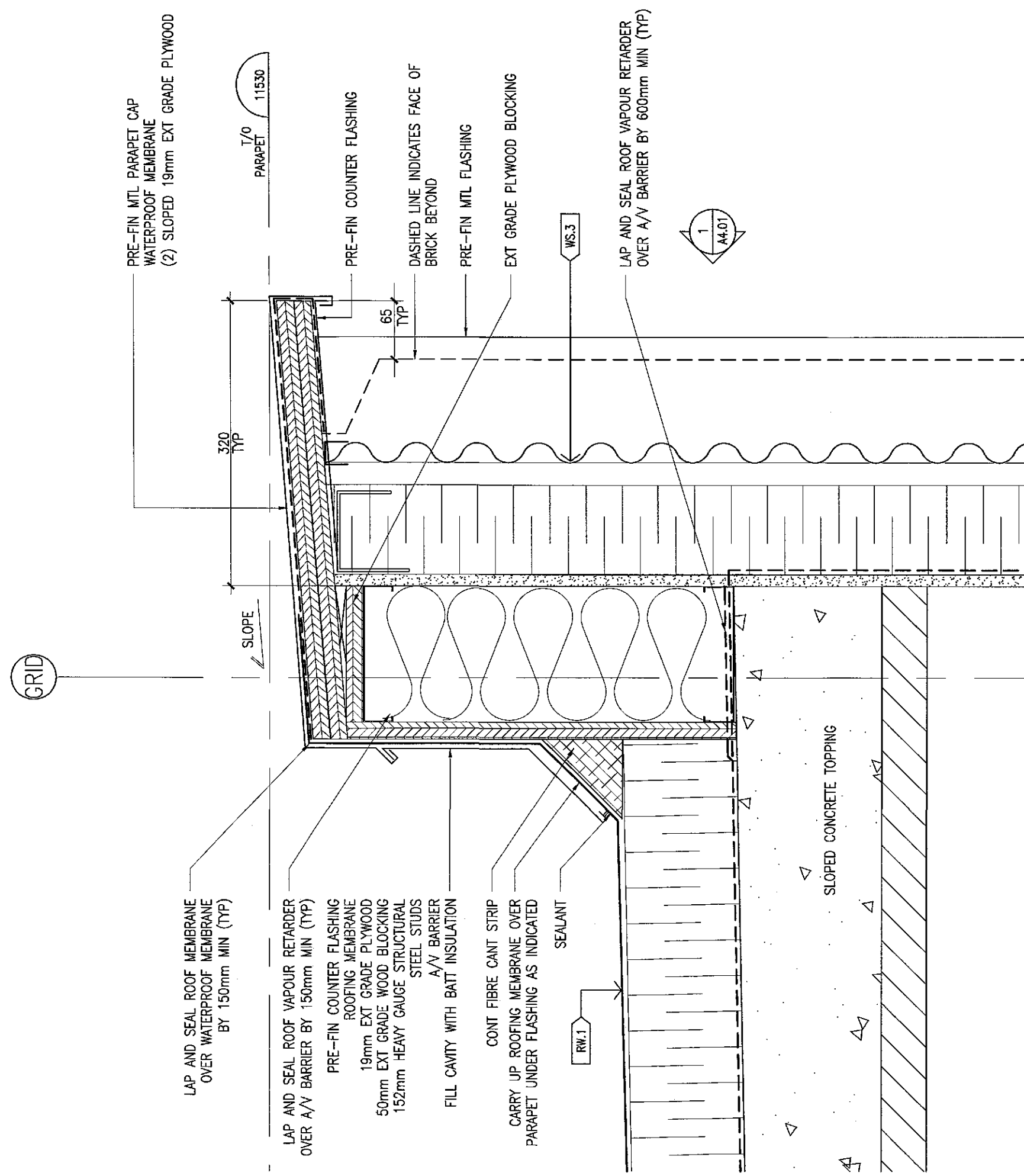

All drawings and specifications are the property of the architect. The contractor shall verify all dimensions and information on site and report any discrepancy to architect before proceeding.

6			
5			
4			
3			
2			
1	09.03.23	ISSUED FOR ADDENDUM NO 3	EC
#	date:	revision:	by:
revisions			

KEY PLAN
 OFFICE BUILDING EXPANSION
 CREDIT VALLEY CONSERVATION AUTHORITY

1255 Old Dwyer Road, Mississauga, Ontario
 Phone: (905) 670-1615 Fax: (905) 670-2210

SECTION DETAIL
 North Wall/WS.3 Wall Parapet

scale:	1:5
drawn by:	EC
reviewed by:	GG
job number:	07008
plot date:	March 23, 2009

drawing number:
D2.33